

UNIBLOCK UB-220 + UB-122 RODS

€ H.10.2 € H.10.3

- Morsettone semiregolabile con aste. Optional supporti LED.
- Adjustable railing clamp with rods. Optional LED support.
- Verstellbare Geländerklemme mit Stangen. Optional LED Auflage.





COMPONENTI / COMPONENTS / EINZELTEILE

**UB-220 AG
UB-220 GR**

- Morsettone balaustra L=220 mm
- Railing clamp L=220 mm
- Geländerklemme L=220 mm

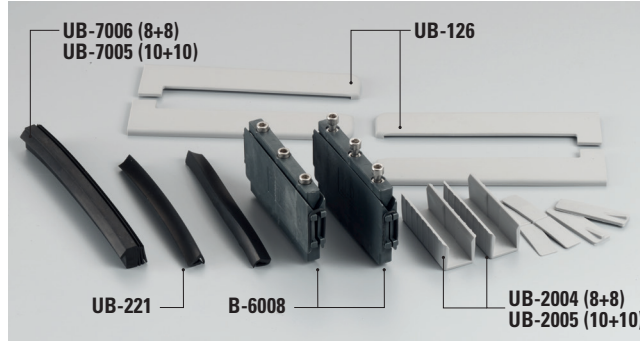

UB-122

- Kit di 4 aste L=3000/6000 mm
- Kit of 4 rods L=3000/6000 mm
- Kit von 4 Stangen L=3000/6000 mm

**UB-SET-220-8
UB-SET-220-10**

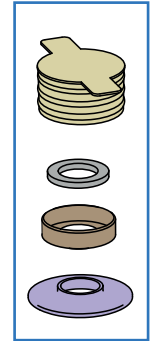
- Set morsetti e guarnizioni
- Set clamps and gasket
- Set Klemmen und Dichtungen

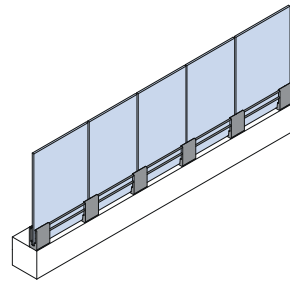
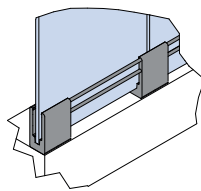
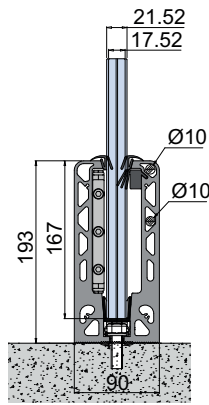
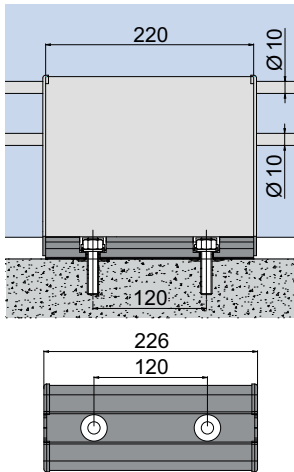
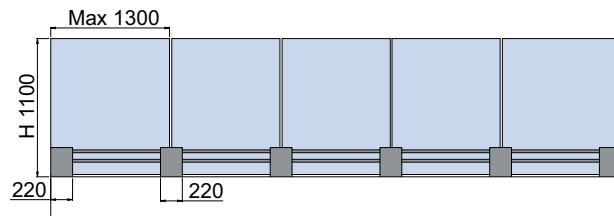
BWC-10

 PAVIMENTO
A PEZZI

 Fori tappi
a cura del
cliente
Endcap
holes by the
customer
Bohrungen
für Endkappe
Bauseits

XME573_EDP

Set completo Complete set Komplett-Set	FIN. FIN. OB.	L=	Vetro Glass Glas	N° UB-220	Testato spinta Test side force Getestete Seitenkraft	Classe Class IT Klasse	ENTE ITALIANO DI NORMAZIONE
*UB-SET-220-8	AG/GR	220 mm	8+8 PVB L=1300 mm	2	150 kg	1	1 kN/m = 100 kg/m
*UB-SET-220-10	AG/GR	220 mm	10+10 SGP L=1300 mm	2	300 kg	2	2 kN/m = 200 kg/m

* senza aste / without rods / ohne Stangen

SET COMPOSTO DA SET CONSISTING OF SET BESTEHEND AUS	FIN. FIN. OB.	UB-220-SET 1,5 KN 8	UB-220-SET 3KN 10
UB-220	AG/GR	1	1
UB-SET-220-8	-	1	-
UB-SET-220-10	-	-	1
UB-122	AN	(1)	(1)

AG
Verniciato argento / Painted silver / Silber lackiert

GR
Grezzo / Raw / Roh